

The Chellington Centre, Bedford

Full Layout / Bedroom Details

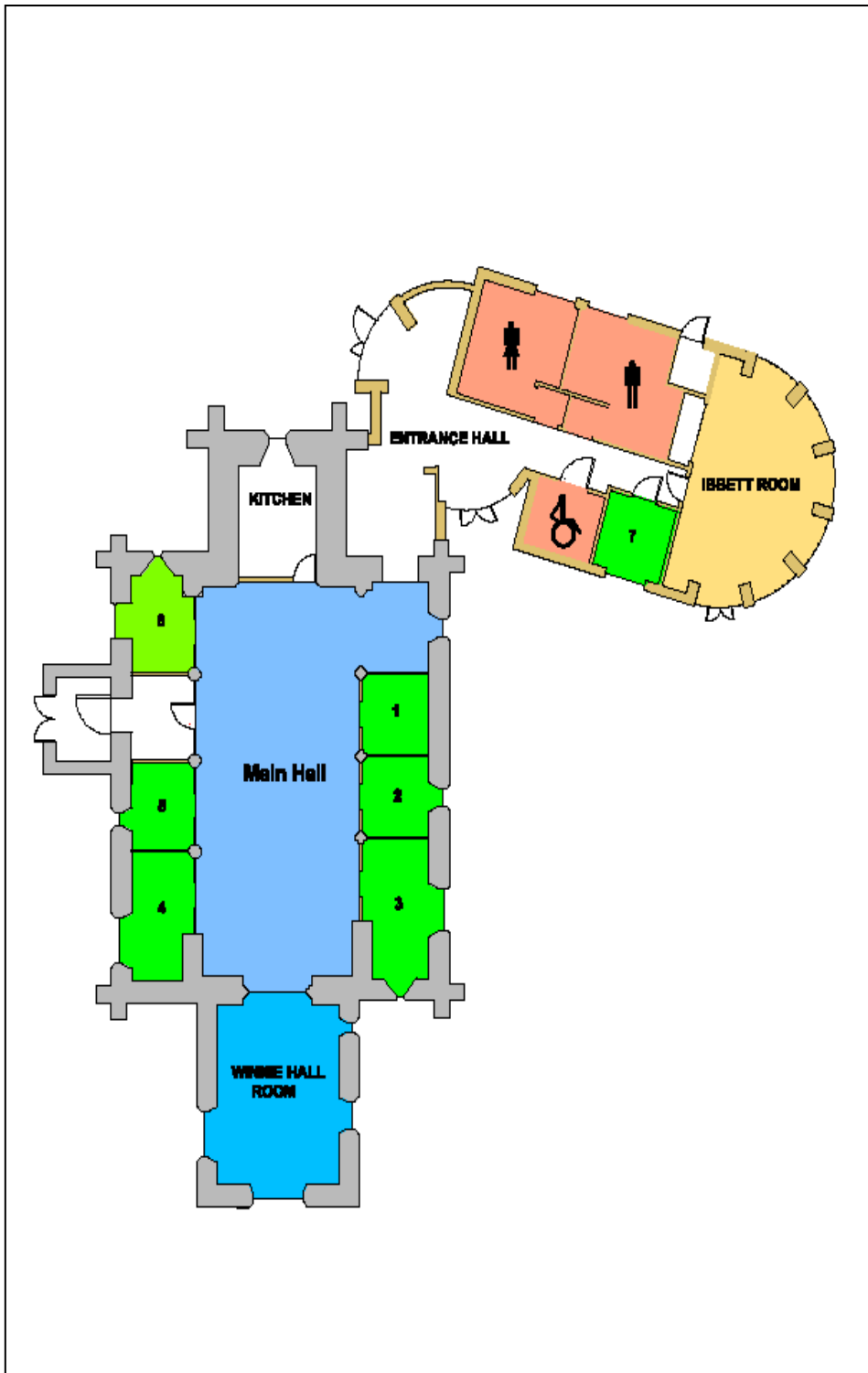

Bedroom 1 – “Bullfinch”

L/L 6' (1.83m)
 L/U 5'10" (1.78m)
 R/L 6' (1.83m)
 R/U 5'10" (1.78m)

Bedroom 2 – “Jackdaw”

L/L 6' (1.83m)
 L/U 6' (1.83m)
 R/L 6' (1.83m)
 R/U 6' (1.83m)

Bedroom 3 – “Redwing”

L/L 6' (1.83m)
 L/U 6' (1.83m)
 R/L 6' (1.83m)
 R/U 6' (1.83m)
 Cent 6' 6" (1.98m)

Bedroom 4 – “Kestrel”

L/L 5' 4" (1.63m)
 L/U 5' 4" (1.63m)
 R/L 5' 4" (1.63m)
 R/U 5' 4" (1.63m)
 Cent 6' 3" (1.91m)

Bedroom 5 – “Magpie”

L/L 5' 6" (1.68m)
 L/U 5' 6" (1.68m)
 R/L 5' 6" (1.68m)
 R/U 5' 6" (1.68m)

Bedroom 6 – “Woodpecker”

L/L 6' (1.83m)
 L/U 5' 10" (1.78m)
 R/L 6' (1.83m) *
 R/U 5' 9" (1.76m) *

Bedroom 7 – “Sparrowhawk”

L/L 6' 3" (1.91m) *
 L/U 6' 3" (1.91m) *
 R/L 6' 3" (1.91m) *
 R/U 6' 3" (1.91m) *